



**IMPORTANT**

1. Always include complete heater model and serial number so that any specification change can be considered for parts shipment. It can save time and expense.
2. Specifications are subject to change without notice.
3. We reserve the right to substitute functional replacements.
4. Order by Part No.; not Heater Option Designation.



**Replacement Parts for Separated-Combustion Models SC, SCA, SCB, SCE, SSCBL, SSCDBL**

**Parts Form P-SC (Version A)**

Obsoletes Form P-SC

Index of Parts by Model and Page	Separated Combustion Models					
	SC	SCA	SCB	SCE	SSCBL	SSCDBL
	Duct Furnace	Unit Heaters		Packaged Systems		
<b>Blowers and Components</b>	--	--	12	12	14	14
Burner Rack and Carryovers	8	8	8	8	8	8
Burner Orifices	8	8	8	8	8	8
Cabinet Parts (Blower Section)	--	--	12	13	14	14
Cabinet Parts (Furnace Section)	4-7	4-7	4-7	4-7	4-7	4-7
Carryover Regulator	8	8	8	8	8	8
Concentric Adapter Box	11	11	11	11	11	11
Contactors (Motor)	--	--	27	27	27	27
Dampers and Controls, Inlet	--	--	--	34	34	34
Drain, Condensate (Option CS)	5	--	--	5	5	5
Drive Components	--	--	29-32	29-32	32-34	32-34
Ductstat	--	--	--	26	26	26
Electrical Components	23-28	23-28	23-28	23-28	23-28	23-28
Evaporative Cooling Module - See Replacement Parts Form P-REC						
Fan and Components	--	11	--	--	--	--
Filter Racks	--	--	--	13	14	14
Filters	--	--	--	13	16	16
Firestat	--	--	--	25	25	25
Furnace (Ht Exchanger) Couplings	--	--	--	--	6	6
Heat Exchanger and Baffles	10	10	10	10	10	10
Limit Controls and Shields	25	25	25	25	25	25
Louvers	--	4	4	4	--	--
Manifold, Special (BM Options)	--	--	--	36	36	36
Manifold, Standard	8	8	8	8	8	8
Maxitrol Components	--	--	--	26	26	26
Motors (Blower)	--	--	17-18	18-22	18-22	18-22
Motor (Damper)	--	--	--	34	34	34
Motors (Fan)	--	11	--	--	--	--
Motors (Venter)	7	7	7	7	7	7
Outlet Nozzle	--	5	5	--	--	--
Pilot	27-28	27-28	27-28	27-28	27-28	27-28
Pressure Switches (Combustion Air)	6-7	6-7	6-7	6-7	6-7	6-7
Pressure Switches (Other)	--	--	27	27	27	27
Relays	24-27	24-27	24-27	24-27	24-27	24-27
Remote Console (Option RC)	--	--	--	28	28	28
Serial Number Designation	2	2	2	2	2	2
Starters	--	--	17-18	18-22	18-22	18-22
Switches, Disconnect	23	23	23	23	23	23
Switches, Toggle	23	23	23	23	23	23
Transformer	24, 27	24, 27	24, 27	24, 27	24, 27	24, 27
Valves (Manual)	9	9	9	9	9	9
Valves (Electric) - See Form P-VALVES; valve is identified by unit Serial No. (see pg 2)						
Venters	7	7	7	7	7	7
Vent/Combustion Air Kits	11	11	11	11	11	11

**Additional References:**

<b>Website</b> (with downloadable files): <a href="http://www.RezSpec.com">www.RezSpec.com</a>
<b>Subject</b> ..... <b>Form</b>
Service - Replacement Gas Valves, Ignition Controllers & Maxitrol Parts ..... P-VALVES
Service - Converting to Other Gases ..... P-GC
Service - Replacement Parts for Optional Evaporative Cooling Module ..... P-REC
Installation/Operation - Model Series SC, Duct Furnace ..... I-SC
Installation/Operation - Model Series SCE Packaged Duct Furnace/Blower ..... I-SCE
Installation/Operation - Model Series SSCBL and SSCDBL Packaged Systems ... I-SSCBL
Installation/Operation - Vent Terminal/Combustion Air Packages ..... I-OPT-VC
Installation/Operation - Optional Evaporative Cooling Modules ..... I-OPT-EC



**Model SCA Unit Heater** (discontinued 2001)



**Model SCB Unit Heater** (discontinued 2001)



**Model SSCBL Packaged System with "BL" Type Blower Cabinet and 1, 2, or 3 Furnace Sections**



**Model SSCDBL Packaged System with two "BL" Type Blower Cabinets and 2, 4, or 6 Furnace Sections (see paragraph on pg 3)**



# Furnace Section Interior Cabinet Parts and Gaskets - All Models

NOTE: Series 5 unit is illustrated. See page 4 for photos of Model SC Series 6 and a Model SSCBL

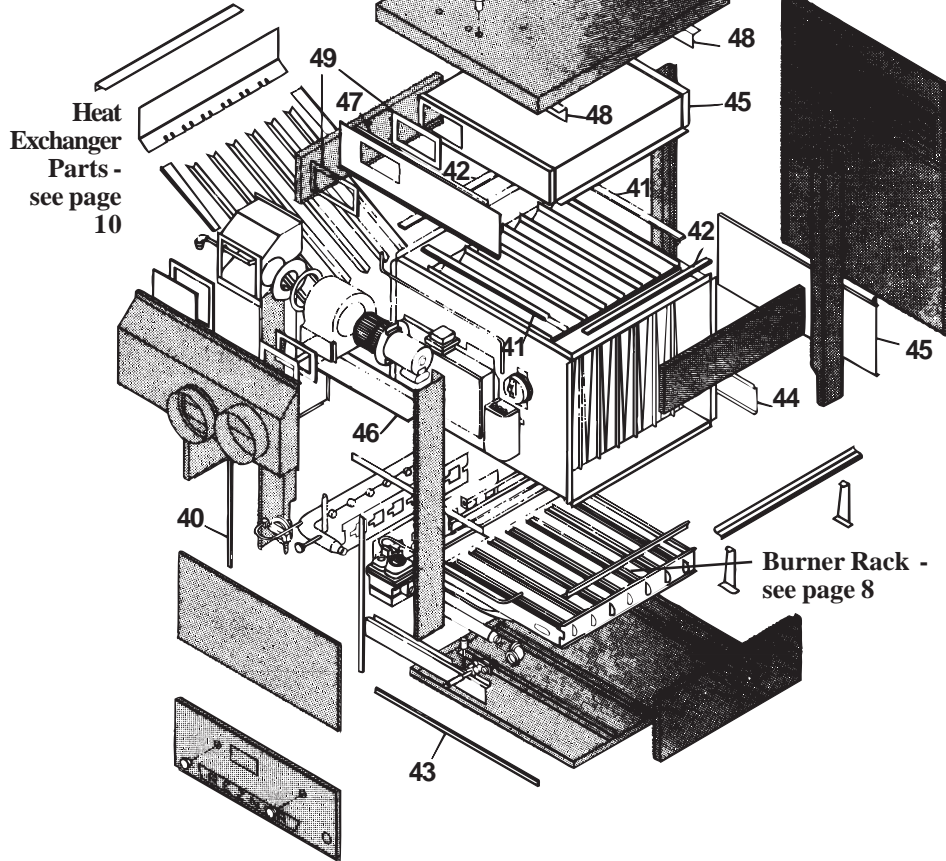

**Connector and Filler Parts (not illustrated) for Connecting Heat Exchangers in Model SSCBL Systems with Two or Three Furnaces**

SSCBL Size	400	500/600	700	800	1050	1200
Top Filler Assy	--	(1)115693	(1)115694	(1)115692	(2)115694	(2)115692
Side Filler	--			(2)105632		
Top & Btm Duct Connector	--	(2)106338	(2)106339	(2)106340	(2)106339	(2)106340
Side Duct Connector	--			(2)106395		

**Code 70 -  
Combustion  
Air Pressure  
Switch**

For units mfgd beginning 7/04 (except SC Series models with Option AG 39, 40, 41, or 42 gas controls) for altitudes to 4000 ft, P/N 204327 setpoint 0.58 ± .05" w.c.; for altitudes above 4000 ft, P/N 204328, Setpoint 0.52 ± .05" w.c.

For SC/SCE units mfgd beginning 7/04 with Option AG39 or 40 and 1st furnace of SSCBL with Opt AG41 or 42 gas controls, P/N 204325 for Sizes 100-225 or P/N 204326 for SC/SCE Sizes 250-400 and SSCBL 400-1200.

For units mfgd between 12/91 and 7/04 (except SC Series Models with Option AG39/40/41/42 gas controls), for altitudes to 4000 ft, order replacement kit P/N 193810; for altitudes above 4000 ft, P/N 193811.

For SC/SCE units mfgd between 12/91 and 7/04 with Option AG39 or 40 and 1st furnace of SSCBL with Opt AG41 or 42 gas controls, P/N 193813 for Sizes 100-225 or P/N 193812 for SC/SCE Sizes 250-400 and SSCBL 400-1200.

For SC Series 3 and 5 and SSCBL prior to 1/94, for altitudes to 4000 ft, P/N 68266, Tri-Delta #FSS100-4871; for altitudes above 4000 ft, P/N 113234.



For SC units prior to Series 3 (9/82), P/N 38712, Cleveland Controls ANA-100-14-20



Code	Description	SSCBL							
		SC(A)(B)(E)	100	125	150/175	200/225	250/300	350	400
40	Gasket on Control Side Corner Leg	SC, SCA, SCB, SCE prior to Series 6	■	90314			90315		
41	Side Gasket (2)		62933						
42	Front and Rear Gasket Strip (2)		62921	62922	62924	62926	62928	62930	
43	Gasket on Control End Bottom Pan	SC, SCA, SCB, SCE prior to Series 6	■	82530					
44	Burner Rack Back Brace		9525						
45	Rear Seal Plate		38616						
46	Radiation Shield	Prior to Series 6 All Series 6	■	68422			125403		
47	Seal Plate		68423			68424			
48	Hanger Angle (2)		31904			11012			
49	Outlet Duct Gasket (2)		31900						
50	Flue Collection Box Assy	Prior to Series 6 Series 6	■	68345	68347	68349	68351	68353	68355
			125264	125265	125266	125274	125275	125276	125469
51	Horizontal Leg Support (not illustrated)		124592 - between right corner leg and heat exchanger						

**Venter Parts for an obsolete Model PV Series unit:**

Size	PV125-175	PV200-400
Replacement Venter Motor - order by voltage (remove housing to install)		
115V	P/N 29992	P/N 29994
208V	P/N 30229	P/N 30233
230V	P/N 30231	P/N 30235
Replacement Venter Sail Switch		
	P/N 7299	P/N 13925
Replacement Combustion Air Switch, Tri Delta #FP 4258, PV125-400, P/N 17155		